

Continuous ink supply system (CISS) is a device that is used for massive printing volumes, such as color copying, instal for home and work operation.

CISS represents a device, which consists of ink tanks with inks, linked with multichannel silicone tube with cartridges identical to the original ones. CISS ColorWay uses high quality inks TM ColorWay.

CISS advantages: volume of donor ink tanks is in 10 - 20 times bigger than the regular cartridges; there is no necessity to eject cartridges from printer during re telling, the air does not enter to the printhead, prolonging its life. And as we know, it's the most expensive part of device; huge savings, more than in 20 - 40 times!

Box content:

1. Ink tanks with rubber stoppers (4 colors) - 1 pcs.
2. Silicone tube (4 channel) - 1 pcs.
3. Tube holder "Clip" - 1 pcs.
4. Cartridges unit (4 cartridges) - 1 pcs.
5. Air filters - 4 pcs.
6. Syringe without needle - 4 pcs.
7. Installation Instruction - 1 pcs.
8. Warranty Card - 1 pcs.

The exterior product view and bundling may differ. Drawings and photos are presented in the manual to understand the general installation and operation process of the CISS. The manufacturer reserves the right to change product specifications, designs and bundling without prior notice.



*Inks optionally: LC123CC-0.0 (without inks); LC123CC-4.5 (4 * 50 ml. inks); LC123CC-4.1 (4 * 100 ml. inks).*

1. Installation preparation

Installation of CISS requires technical information how to install it so we advise you to read instruction before installation.

Before installation please check the whole system and box content.

During the period of CISS usage please do not touch chips and printing heads of original cartridges, do not let dust and liquids to make them broken.

Attention! When you install CISS to a new printer, first printer start must be with a using of the original cartridges.

1.1. Before installation of CISS makes sure the printer is in working condition: make sure the printer works well with original cartridges and paper supply mechanism is fine. If the printer is new and it is been never used before so please go to p.1.4.

1.2. Before system installation make sure that your cartridges have never been refilled before, since depending on the way of refilling the cartridge impermeability may be broken what may lead to system inability to work. If you have been using inks of another manufacturers that differs from CISS inks, please remove old inks from cartridges. For this is convenient to use a syringe with needle to pull out old inks. After you need to fill cartridges with set inks. (see p.2.1.) and to check their workability.

1.3. Please print test page to evaluate printer ability to work. (See instructions Printers). If test is positive so please start CISS installation.

If result is negative so please follow the recommendations on cleaning printing head via software of printer (Pic. 1) Service, button Cleaning, deep cleaning, if this does not bring positive effect so please replace broken cartridge to a new one.

1.4. Get straight a silicone tube, it should be in fine working condition. Let CISS to lie for a while for getting room temperature.

1.5. All procedures are recommended to be organized in a way to avoid getting inks on furniture, floor and clothes.

Reminder! The fact that in a printer is used non original consumables can be used as a reason of warranty cancellation. Make sure that your printer is compatible with this system (list of compatible printer models is on a side label of box).

Attention! If previously you have been using low quality inks or you change now pigment inks into dye inks or dye inks into pigment inks. In this case please clean a printing head before printing with a special cleaning liquid. If you have been using original inks or inks of TM ColorWay in this case no need to clean printing head.

2. Ink tank refilling

PLEASE NOTE: INK VERY BADLY WASHED OFF, PLEASE ORGANIZE ALL THE PROCEDURES VERY CAREFULLY!

INK CAN RUIN YOUR FURNITURE AND CLOTHES; MAKE SURE THAT YOUR WORKING SPACE AND CLOTH ARE NOT CHERISHED.

Fill in the ink tanks as it shown on Pic. 1:

2.1. Plug small aperture with the rubber;

2.2. Inject ink though the big aperture;

2.3. Plug the big aperture;

2.4. Unplug the small aperture, insert the air filter;

2.5. In case big apertures weren't plugged, ink level in both chambers will become equal. In this case you have to unplug both chambers, insert the syringe with pulled back plunger into the small aperture. Carefully push the syringe plunger down, injecting the air into the small chamber and transferring ink into the big chamber. Than plug the big aperture (Pic. 2 – images 5).

In-service ink tanks should be correctly filled-in: please pay attention to operating level of ink in small chamber – it should be minimal.

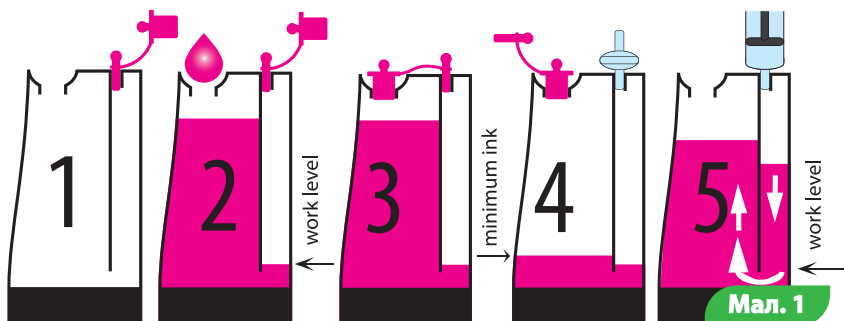

3. System pumping.

When you first install the system, you should properly pump the system: fill the tube and ink cartridges.

3.1. For system pumping, take one of the cartridges - gently take out the rubber stopper on the top of the cartridge. (Pic. 2-3)

3.2. Insert the syringe without needle into a hole and slowly pull the plunger of the syringe up, in this way inside a cartridge is formed vacuum space and you can see how inks from ink tanks will filling the cartridge (Pic. 4) - if it will be necessary, this procedure should be repeated until the syringe will start filled with inks.

3.3. Remove the syringe from the cartridge and close the hole with a rubber stopper.

3.4. Take a clean syringe and similarly fill other cartridges of the CISS.

If picking up the syringe plunger, there is a "vacuum" - syringe plunger seeks to return or plunger rises hardly - look carefully the whole course of the movement of the ink from the ink tanks to the print cartridge, to be shure that the tube not jammed or twisted.



4. Ink cartridges installation and tube laying

1. Open the cover of the cartridges .
2. Remove from the printer (MFPs) original ink cartridges. (Pic.7)
3. Install the CISS cartridges into the printer until they click on their place (Pic.8). Before installation, pay your attention on the position of the float inside the cartridge. (Pic.5-6)
4. Secure the sensor of the printer cover opening using means at hand, such as a piece of paper, or make a cut in the printer cover for the tube (note that the mechanical action on body of the printer (MFPs) can be a grounds for warranty refusal). (Pic.9)
5. Close the cover of the cartridges .

! Do not dispose an original cartridges, they can need you. Do not leave a printer for a long time without ink cartridges, it can lead to drying of the Print Head Nozzles.

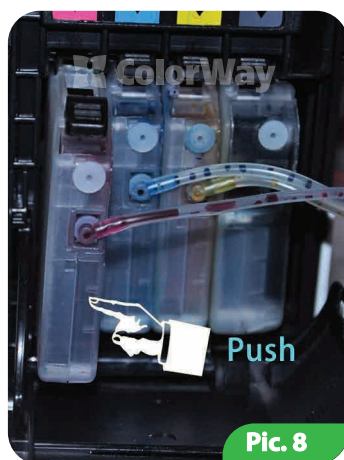
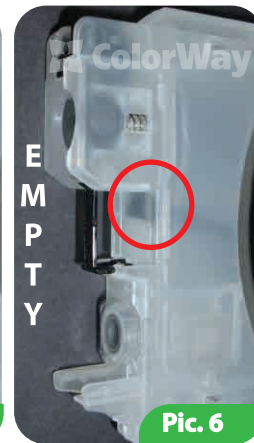
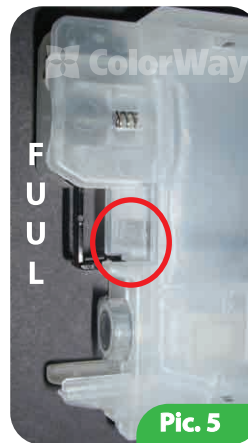

5. System start-up

! Before system start, please monitor whether you strictly followed to all instructions in section 2. Ink tank refilling. Make sure that ink tanks are on the same level with the printer, and air holes are open.

- 5.1. Switch on printer (MFPs). Wait until all operations are performed by printer, wait until printer is ready to be used.
- 5.2. With a help of printer (MFPs) driver, please make 2-3 cleaning operations of nozzles and after print nozzle check in order to make sure that all nozzles work properly. If some nozzles do not print, leave the printer for few hours, over this time excessive air gets out from the printing head and system pressure gets stabilized. If it doesn't help please organize again pumping of cartridges and also see part 1 of this manual.

5.3. Ink is a cooler for printing head of printer. Lack of ink inside cartridges may damage the printer. If printer stands for a long time without work and in silicone tube is lots of air, it is necessary to pull out bloc of cartridges from the printer and to pump system again – Part 3 of this manual.

6. Resetting of the cartridges

- 6.1. If your printer has issued notice that one of the cartridges are empty or printer cannot recognize it, you should to reset the ink level. Use the printer driver or look the instructions for the printer, chapter "Replacing cartridges".
- 6.2. Open the cartridges cover or remove a piece of paper from the sensor of the printer cover opening , unclick the cartridges for 3-5 seconds.
- 6.3. After 3-5 seconds click the cartridges back.
- 6.4. If you have any problems with cartridges resetting , turn off and after a couple of minutes, turn on the printer. Remove all cartridges from the carriage, when the carriage is in the "cartridges replacement" position for 2-3 seconds and then install them back until they click on their place.
- 6.5. Printer (MFP) will show a notice that the ink cartridges are empty when the printer (MFPs) will spend a volume of inks the same as the volume of inks in the original cartridge.

7. Ink tanks binding

- 7.1. CISS box includes clinchers for ink tanks and if it is necessary you may stick tanks to the printer. Please follow instructions on shown picture 10, 11, 12).

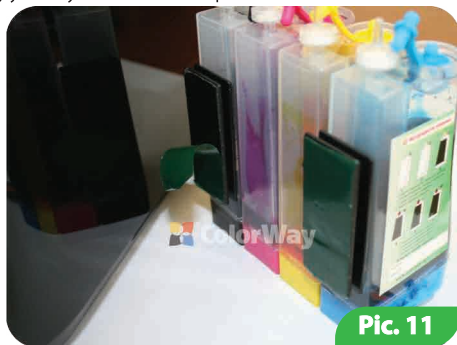

8. Service regulations of CISS

- 8.1. External ink tanks should be filled correctly. A minimum level of inks should be in small ink tanks (2. Ink tank refilling). In case when in small tank too much of inks (Pic. 13), close all caps of tanks (Pic. 13). Tilt tanks on big caps and wait until inks will go from big tanks to small tanks (Pic. 14). Get tanks in standard position and open small caps (Pic. 15). Put in air filters.
- 8.2. Big holes in tanks should be closed and small holes open with air filters.
- 8.3. External ink tanks should be standing on the same level with printer, do not lift them higher than level of cartridges because it may cause leakage. If air filters do not work properly due to various reasons please remove them and use system without them.
- 8.4. A Silicone tube should be installed properly and do not obstruct a movement of printing head.
- 8.5. Print no less than 1 time a week to avoid printing head drying.
- 8.6. Use only high quality inks, do not mix inks of various brands and types. It may harm cartridges or printing head.
- 8.7. During printing do not get upside down ink tanks.
- 8.8. Use CISS in clean room at temperature of 15-35 C.
- 8.9. Do not get separate CISS parts. For getting the best printing quality please use inks and paper TM ColorWay.
- 8.10. Keep out of the reach of children, do not let inks to harm eyes.



9. Transportation of CISS with printer.

9.1. Put out air filters and close with caps small halls in order to avoid leakage.

9.2. Bind with binder a silicone tube that comes from CISS to printer.

9.3. Transport a printer with CISS in horizontal position, do not get printer upside down. For more convenience you can stick air tanks to printer.

10. Questions and answers

Not printed well some places (pictures/text). In case when you have done a couple of times cleaning of printing heads and still printing head prints with white stripes.

Solution: cleaning of printing head several times, after each cleaning procedure make a test page. Between cleaning procedure make a pause for 5-10 min. If it does not help so please switch off printer and leave it for 12 hours in this condition. After this print a test page. If problem remains, please install original cartridges, if the same problem remains so problem with printer, please make a service for your printer.

Air bubbles in a silicone tube. In case if cleaning do not lead to positive result and problems remains. Solution is to do again p.3. System pumping, Probably in cartridges of CISS is not enough of inks.

A silicone tube is bended. In case when one or two colors do not work. Solution: please print a test page and check the whole length of silicone tube. After removing of bends please make cleaning of printing head.

Unnatural colors of printing. In case when all colors are unnatural. Solution: all cartridges should meet the respective color that is stated on a carriage of printing head. If colors mixed please wash system and refill it again in accordance with right order.

Poor printing quality. In case if a test page is printed well but printing quality is low. Solution: problem is printing settings, software installed incorrectly. Please change printer settings. Other reason might be not calibrated printing head. To fix it you need to calibrate (see instructions to the printer). During printing appears problems with colors or mix of color it might be the end of printing head life.

Printer does not recognize cartridges. In case: if indicator of ink replacement is on and after you properly clicked cartridges in carriage and performed p.6. and printer driver on computer says No cartridge or replace cartridge. Solution: cartridge is not properly installed in carriage or chip on cartridges are broken or dirty. In order to solve a problem you need to put out cartridges from carriage and fix, clean or replace. And after to install cartridges until click.

Problem with CISS installation. In case: when printer says General Error or your printer needs service

Solution: during the printing a carriage cannot move. A silicone tube might be too short of long, please adjust a necessary length of silicone tube. If an external part gets in a printer, please check printer body on any external parts.