

Attention! This universal instruction presented for several models of CISS!

Continuous ink supply system (CISS) is a device that is used for massive printing volumes, such as color copying, instal for home and work operation.

CISS represents a device, which consists of ink tanks with inks, linked with multichannel silicone tube with cartridges identical to the original ones. CISS ColorWay uses high quality inks TM ColorWay.

CISS advantages: volume of donor ink tanks is in 10 - 20 times bigger than the regular cartridges; there is no necessity to eject cartridges from printer during re telling, the air does not enter to the printhead, prolonging its life. And as we know, it's the most expensive part of device; huge savings, more than in 20 - 40 times!

Box content:

1. The ink tanks unit with stoppers 6 colors - 1 pcs.
2. Holder of the ink tanks unit - 2 pcs.
3. Silicone tube with 5-channel - 1 pcs.
4. Metallic holder tube - 1 pc.
5. Straight holder- 1pc.
6. Block Cartridges (6 pcs) - 1 pcs.
7. Air Filter - 6 pcs.
8. Syringe with needle - 6 pcs.
9. Rubber pads - 6 pieces.
10. Installation Instructions - 1 pc.
11. Warranty Card - 1 pc.

Recommended ink:

Black ink on choices: **CW-CP510BK** - pigmented inks (not be mixed with CW-CW520BK);

CW-CW520BK - dye ink (not be mixed with CW-CP510BK);

Coloured - **CW-CW521C**; **CW-CW521M**; **CW-CW521Y**; CW-CW820G;

The exterior product view and box content may differ. Drawings and photos are presented in the manual to understanding the general installation and operation process of the CISS. The manufacturer reserves the right to change product specifications, designs and box content without prior notice.

*Inks optionally: code-0.0 (without inks); code-4.5 (4 * 50 ml. inks); code-4.1 (4 * 100 ml. inks); code-5.5P(1P+4*50 ml(P-with one pigment ink)).*



1. Installation preparation

Installation of CISS requires technical information how to install it so we advise you to read instruction before installation.

Before installation please check the whole system and box content.

During the period of CISS usage please do not touch chips and printing heads of original cartridges, do not let dust and liquids to make them broken.

1.1. Before installation of CISS makes sure the printer is in working condition: make sure the printer works well with original cartridges and paper supply mechanism is ne. If the printer is new and it is been never used before so please go to p.1.3.

1.2. Please print test page to evaluate printer ability to work.

Reminder! The fact that in a printer is used non original consumables can be used as a reason of warranty cancellation.

If test is positive so please start CISS installation.

If result is negative so please follow the recommendations on cleaning printing head via software of printer (Pic. 1) Service, button Cleaning, deep cleaning, if this does not bring positive e ect so please replace broken cartridge to a new one.

1.3. Colors sequence of cartridge bloc and external ink tanks may vary. Before installation and lling of CISS it is necessary to check the accuracy of colors sequence, for this check the printer carriage and compare with cartridges bloc and external ink tanks. If it is necessary replace stickers that refer to colors on tanks and rubber caps in respective sequence. Also it is necessary to replace cartridge in accurate sequence, for this remove connector that is connected with silicone tube from the cartridges, put cartridge in the accurate place and get connector back. For Printers/MFPs: Canon PIXMA **IP7250/MG5450/5550/6550** sequence of the Ink tanks should be: **M/BK/Y/BK/C/**. For MFPs: Canon Pixma **MG 6350/7150** sequence of the Ink tanks should be: **BK/GR/Y/BK/C/M/**.

1.4. Get straight a silicone tube, it should be in ne working condition. Let CISS to lie for a while for getting room temperature.

1.5. All procedures are recommended to be organized in a way to avoid getting inks on furniture and your clothes

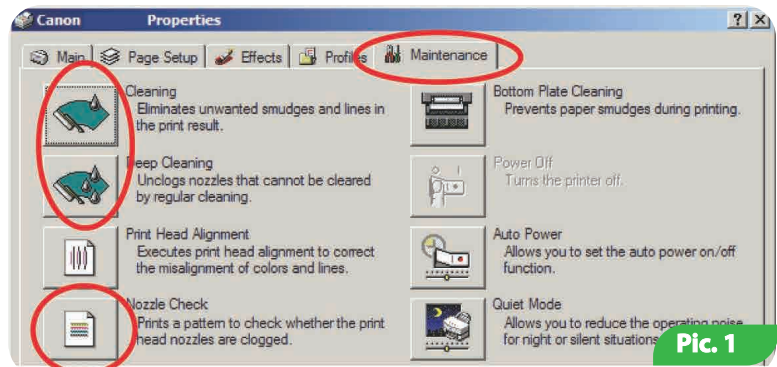

Pic. 1

Attention! If you have previously used the supplies of dubious quality, and when changing ink - pigment into water-soluble and vice versa. Before installing the printer, you need to rinse the printhead special washing liquid. If you used the original consumables or materials ColorWay, then there is no need to wash - we guarantee you quality results. We offer ink is fully compatible with original ink and so when you install the system you do not have to resort to washing the printhead.

2. Ink tank refilling

PLEASE NOTE: INK VERY BADLY WASHED OFF, PLEASE ORGANIZE ALL THE PROCEDURES VERY CAREFULLY!

INK CAN RUIN YOUR FURNITURE AND CLOTHES; MAKE SURE THAT YOUR WORKING SPACE AND CLOTH ARE NOT CHERISHED.

Fill in the ink tanks as it shown on Pic. 2:

2.1. Plug small aperture with the rubber;

2.2. Inject ink though the big aperture;

2.3. Plug the big aperture;

2.4. Unplug the small aperture, insert the air filter;

2.5. In case big apertures weren't plugged, ink level in both chambers will become equal. In this case you have to unplug both chambers, insert the syringe with pulled back plunger into the small aperture. Carefully push the syringe plunger down, injecting the air into the small chamber and transferring ink into the big chamber. Than plug the big aperture (Pic. 2 – images 5).

In-service ink tanks should be correctly filled-in: please pay attention to operating level of ink in small chamber – it should be minimal.

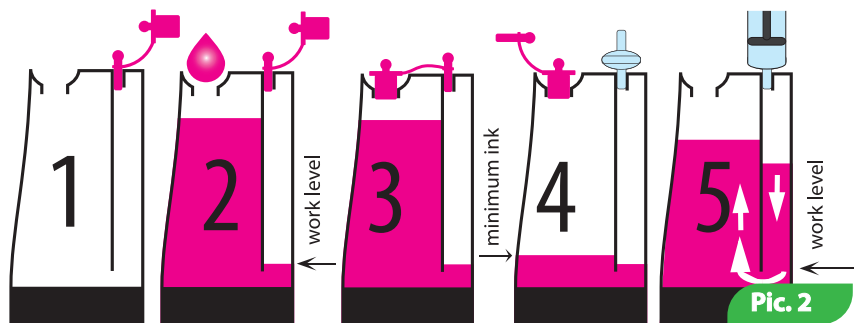

Pic. 2

Note: Do not place ink tanks higher than level of cartridges (printing head) it may cause leakage. Due to excess pressure ink can goes into the printer and may spoil printing head and electronic contacts. Keep the ink tanks on the same level with the printer. The air filters (membrane) should be clean and dry. If the air filter is moisten with ink or any other liquid – it stops passing the air and CISS stops working properly (the missing colors are observed on printouts). In this case it'll be better to take filter away and use the CISS without it.

3. System pumping

During first system installation, it is necessary to pump system it means to fill silicone tube and cartridges with inks.

3.1. Carefully open the rubber stopper on the top of the cartridge. (Pic. 3)

3.2 insert into the pumping hole the nozzle of the syringe without a needle and tilt the cartridge on 90°, slowly pull the plunger up. You will see how the ink will flow through an elastic tube to the cartridge. When the ink cartridge is completely filled you should stop the syringe plunger. (Pic. 4-8) - the procedure should be repeated if necessary, until in the syringe will not trap ink.

3.3. Carefully remove the syringe.

3.4. Take a clean syringe and similarly pump all other cartridges.

Cartridges should be filled in completely, otherwise in further exploitation probable that an outflow of ink.

If picking up the syringe plunger, there is a "vacuum" - syringe plunger seeks to return or plunger rises hardly - look carefully the whole course of the movement of the ink from the ink tanks to the print cartridge, to be shure that the tube not jammed or twisted.

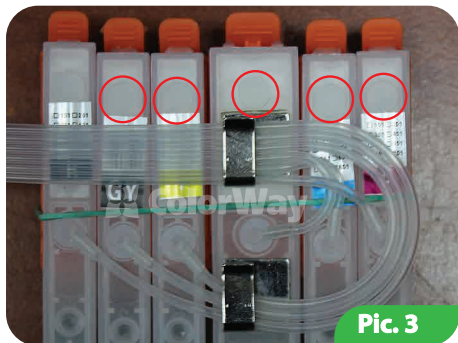

Pic. 3



Pic. 4

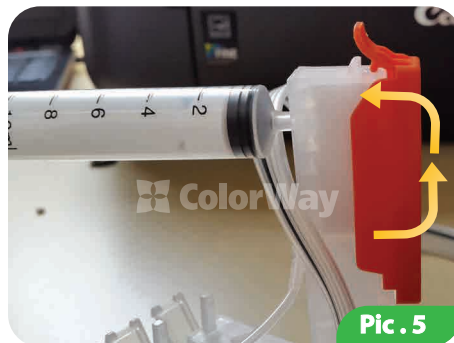

Pic. 5

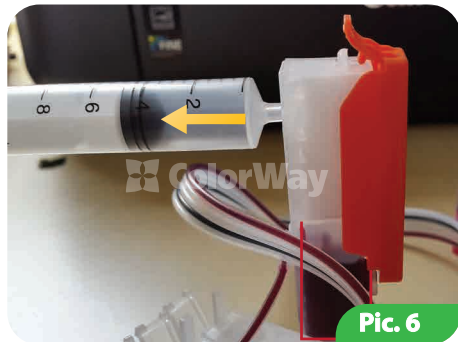

Pic. 6



Pic. 7

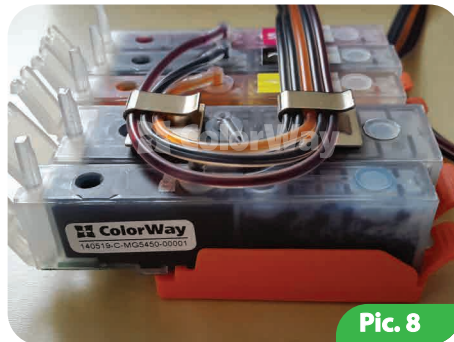

Pic. 8

4. Preparing the Printer

For proper operation of the MFPs you should install the rubber seals that in the Box content.

- 4.1. Turn on the printer, open the cover to access the ink cartridges.
- 4.2. The carriage will move to cartridges replacement position.
- 4.3. Remove the original ink cartridges.
- 4.4. Then pull part of the carriage with a labels of color of the ink cartridges until it clicks. (Pic. 9)
- 4.5. Take the print head for a partition in the center, and gently pull it toward you. (Pic. 10-11)

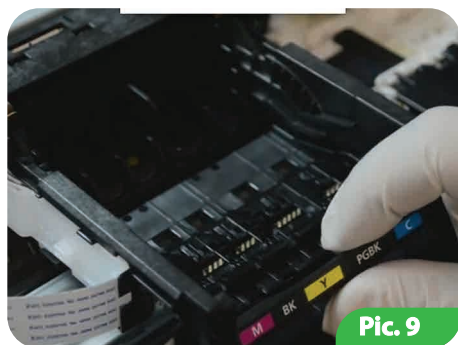

Pic. 9



Pic. 10

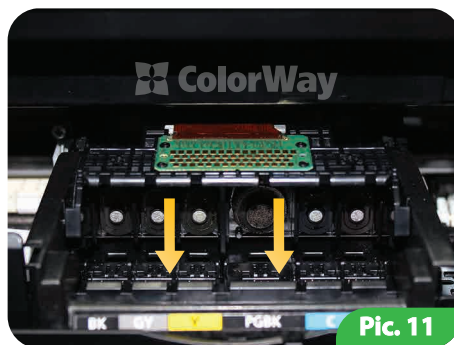

Pic. 11



Pic. 12



Pic. 13



Pic. 14

- 4.8. Carefully remove the original rubber seals. (Pic. 12-13)
- 4.9. Install the rubber seals from Box content. (Pic. 14)
- 4.10. Install original rubber seals on top of the rubber seals from Box. (Pic. 15)
- 4.11. Install the print head in the reverse order back to the printer carriage.

5. CISS installation

- ! Before you begin the process of securing the tube - you should clearly understand the principle of tube motion while the printer is printing, as well as to understand the basic principles of tube securing:**
- Rule 1: The lengths of the tube should be enough for the free movement of the print head from the far right position - to the far left position;**
- Rule 2: The tube can be bent and touch the body of the printer when the print head is moving, but the tube shall not stuck or be jammed between moving and stationary parts of the printer!**

- 5.1. Make sure that the cartridges are fully filled. (Pic. 8)
- 5.2. Clamp the tube, use for this a Binder clip. (Pic. 16)
- 5.3. Before installing the cartridges unit in the printer carriage note that the tube must be fixed exactly perpendicular to the holder on the cartridges unit. (Pic. 17). If the tube is not exactly perpendicular to the holder, it is possible to break of the tube holder that will lead to jamming of the carriage. The tube holder should strongly secure the tube on the cartridges unit and do not give it to shake.
- 5.4. Turn the cartridges unit up side down (Pic. 18)
- 5.5. Gently (DO NOT USE A LOT OF EFFORT) to avoid inks flowing out from the cartridges, remove the orange caps. To remove the caps and do not break it, latch of a caps need to unclip and slide toward the back of the cartridge. (Pic. 19, 20).
- WARNING !!! The caps do not discard. You will need them for later use.**
- 5.6. Before you install the ink cartridges in the printer, check color order. (Pic. 21).
- 5.7. Install the cartridges unit into the printer carriage. (Pic. 22).
- 5.8. In order to pave the tube you should unclip lower fastening of the cartridges cover. To do this, behind fastening, without effort, push down on the latch and slide the fastening to back side of the MFPs. (Pic. 23). Lift up fastening.
- 5.9. Secure the straight holder on the right side of the MFP, so that the right end of the holder was at the same level with the right fastening of the cartridges cover. (Pic. 24)



Pic. 15

5.10. Stick the double-sided tape on the left side of the straight holder. (Pic. 24-26) It's needed to tube securing in correct position.

5.11. Secure the tube in the straight holder. (Pic. 27)

5.12. Move the carriage to the far left position. Then move the carriage from the far left position to the far right position. The tube shall not stuck or be jammed when the carriage in movement. If it's necessary, tighten or loosen the tube. (Pic. 28-29)



Pic. 16



Pic. 17



Pic. 18



Pic. 19



Pic. 20



Pic. 21



Pic. 22



Pic. 23



Pic. 24



Pic. 25

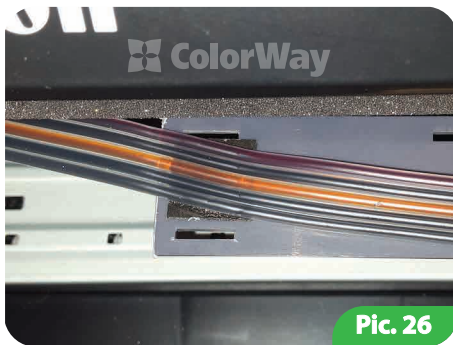

Pic. 26



Pic. 27

Correct position of the tube and following all the manuals to installing the holders it is the key to successful work of the CISS with a printer.(Pic. 30-32)

5.13. Secure the fastening of the cartridges cover. (Pic. 33.34)

5.14. If you turn on the printer and will see message "Cover Open" You need to secure the sensor of cartridges cover opening improvised means, such as a piece of paper. (Pic. 35, 36)



Pic. 28

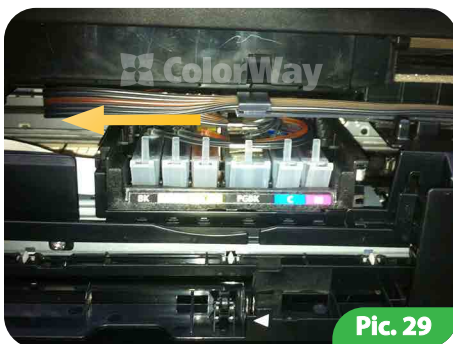

Pic. 29

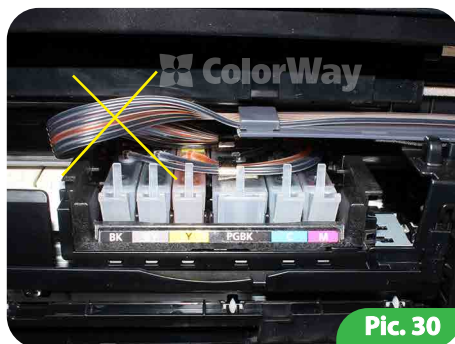

Pic. 30



Pic. 31



Pic. 32



Pic. 33



Pic. 34



Pic. 35



Pic. 36

5.15. Open a small hole of ink tanks, insert the air filter. (Pic. 37)

5.16. Remove the binder clip.

5.15 CISS comes with holders for ink tanks, if necessary, you can secure the ink tanks on the printer body. To do this, remove the protective strip from the holders of the ink tanks, pay attention that the "keys" of the holders was in one direction (Pic. 3), otherwise you will not be able subsequently to disconnect the ink tanks. Then remove the protective strip from other side of the holder (Pic. 20) and secure the ink tanks on the printer body (Pic 40). Ink tanks should stand on the same level with the printer.



Pic. 37



Pic. 38

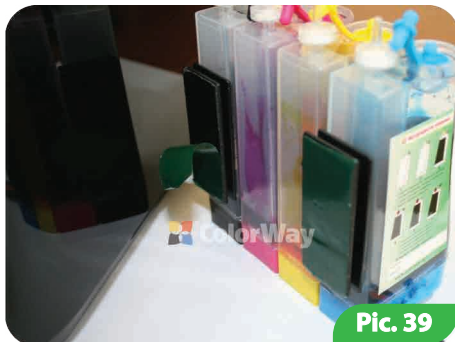

Pic. 39

6. System start-up

! Before system start, please monitor whether you strictly followed to all instructions in section 2. Ink tank refilling. Make sure that ink tanks are on the same level with the printer; and air holes are open.

6.1. Switch on printer (MFU). Wait until all operations are performed by printer, wait until printer is ready to be used.

6.2. With a help of printer (MFU) driver, please make 2-3 cleaning operations of nozzles and after print nozzle check in order to make sure that all nozzles work properly. If some nozzles do not print, leave the printer for few hours, over this time excessive air gets out from the printing head and system pressure gets stabilized. If it doesn't help please organize again pumping of cartridges and also see part 10 of this manual.

6.3. Ink is a cooler for printing head of printer. Lack of ink inside cartridges may damage the printer. If printer stands for a long time without work and in silicone tube is lots of air, it is necessary to pull out bloc of cartridges from the printer, to put on orange caps on the cartridges and to pump system again – Part 3 of this manual.

6.4. In case of unacceptable printing quality (after nozzles test and few cleaning procedures) remove rubber gasket from the cartridge that during printing gives the worst printing quality.



CISS comes with autochips, if MFU (printer) gives a message that ink is over. It is necessary to switch off and then switch on the printer. If it does not help press and hold the button Cancel on the front panel for 10 sec (red circle with triangle inside). With a help of this you switch off ink control, after this printer may give a message of low ink level or that it is impossible to identify ink level but printer continues to print. For each color it is necessary one time to switch off ink level control.

7. Service regulations of CISS

7.1. External ink tanks should be standing on the same level with printer, do not lift them higher than level of cartridges because it may cause leakage. If air filters do not work properly due to various reasons please remove them and use system without them.

7.2. A Silicone tube should be installed properly and do not obstruct a movement of printing head.

7.3. Print no less than 1 time a week to avoid printing head drying.

7.4. Use only high quality inks, do not mix inks of various brands and types. It may harm cartridges or printing head.

7.5. During printing do not get upside down ink tanks.

7.6. Use CISS in clean room at temperature of 15-35 C.

7.7. Do not get separate CISS parts. For getting the best printing quality please use inks and paper TM ColorWay.

7.8. Do not keep it under direct sun light.

7.9. Keep out of the reach of children, do not let inks to harm eyes.

8. Transportation of CISS with printer.

8.1. Put out air filters and close with caps small halls in order to avoid leakage.

8.2. Bind with binder a silicone tube that comes from CISS to printer.

8.3. Transport a printer with CISS in horizontal position, do not get printer upside down. For more convenience you can stick air tanks to printer.

9. Questions and answers

Not printed well some places (pictures/text). In case when you have done a couple of times cleaning of printing heads and still printing head prints with white stripes.

Solution: cleaning of printing head several times, after each cleaning procedure make a test page. Between cleaning procedure make a pause for 5-10 min. If it does not help so please switch off printer and leave it for 12 hours in this condition. After this printing a test page. If problem remains, please install original cartridges, if the same problem remains so problem with printer, please make a service for your printer.

Air bubbles in a silicone tube. In case if cleaning do not lead to positive result and problems remains. Solution is to do again p.3. System pumping, Probably in cartridges of CISS is not enough of inks.

A silicone tube is bended. In case when one or two colors do not work. Solution: please print a test page and check the whole length of silicone tube. After removing of bends please make cleaning of printing head.

Unnatural colors of printing. In case when all colors are unnatural. Solution: all cartridges should meet the respective color that is stated on a carriage of printing head. If colors mixed please wash system and refill it again in accordance with right order.



Pic. 40

Poor printing quality. In case if a test page is printed well but printing quality is low. Solution: problem is printing settings, software installed incorrectly. Please change printer settings. Other reason might be not calibrated printing head. To fix it you need to calibrate (see instructions to the printer). During printing appears problems with colors or mix of color it might be the end of printing head life.

Printer does not recognize cartridges. In case: if indicator of ink replacement is on and after you properly clicked cartridges in carriage and performed p.6. and printer driver on computer says No cartridge or replace cartridge. Solution: cartridge is not properly installed in carriage or chip on cartridges are broken or dirty. In order to solve a problem you need to put out cartridges from carriage and fix, clean or replace. And after to install cartridges until click.

Problem with CISS installation. In case: when printer says General Error or your printer needs service

Solution: during the printing a carriage cannot move. A silicone tube might be too short or long, please adjust a necessary length of silicone tube. If an external part gets in a printer, please check printer body on any external parts.